

Bottom Mount Reach-In Refrigerators – EB Series

Bottom Mounted Condensing Unit



EBR1

EBWR1

EBWRH2



EBNR2

EBSR2



EBR2



EBR3

Cabinet Construction

- Heavy duty stainless steel interior / exterior with rounded corners for a hazard-free workspace.
- Open spaced interior with no walls between compartments.
- Galvanized steel top, bottom and rear.
- 2.5" thick high density polyurethane insulation.
- Deeper cabinet interior for more storage options.
- Four 5" swivel casters with locks on front set (six for model EBR3). Leg stabilizers standard for all models.

Refrigeration System

- Bottom mounted, self-contained and fully detachable Blizzard R290 condensing unit uses environmentally friendly, EPA-compliant R290 refrigerant with zero (0) Ozone Depletion Potential (ODP) and three (3) Global Warming Potential (GWP). Blizzard R290 is easily replaceable and requires no on-site brazing.
- Electronically commutated (ECM) fan motors achieve rapid cooling with less energy consumption.
- Full-length air duct and airflow guard ensure optimal cold air circulation.
- Time-initiated and temperature-terminated auto defrost cycle for seamless operation.
- Large capacity, corrosion-resistant condenser and evaporator coils.
- Self-maintaining, energy-efficient condensate drain pan requires no external drains or electric heaters.
- High performance, auto-reverse condenser fan motor supports compressor ventilation and condenser coil cleaning.
- Pressure relief devices allow rapid cabinet re-entry.
- Pre-wired and ready to plug, 115V/60Hz/1Ph, NEMA 5-15P.

Lighting

- Energy efficient silicone coated and shatter-proof LED lighting provides bright, high color illumination with low heat output.

Doors

- Heavy duty stainless steel interior / exterior.
- 2.5" thick high density polyurethane insulation.
- Frame heaters prevent exterior moisture build up.
- Self-closing with adjustable torsion system for a positive seal.
- Snap-in magnetic gasket for ease of cleaning.
- High strength, recessed handles.
- Pre-installed locks keep your items safe from theft.
- Field reversible.

Shelving

- Three epoxy coated, steel wire shelves per section.
- Height adjustable stainless steel clips.

Temperature Control

- Multi-function digital controller with easy to read LED display.
- Factory preset temperature, 35°F. Temp-set range from 33°F to 54°F.
- Audible overheat protection alarm for compressor and condenser coil.

Options

- Additional shelving.
- Baking sheet pan racks for models EBR1, EBWR1 and EBWRH2.
- 3" swivel casters with locks.
- 3.5" – 6" height-adjustable and interchangeable legs.
- Left hinged door.

↔ = Interior Dimensions ↔ = Exterior Dimensions

ABS Legs



Two additional front adjustable stainless steel clad ABS legs provide extra stability when opening and closing door, and three additional legs for EBR3 for weight support.

Vacuum Relief Mechanism



The vacuum relief valve equalizes cabinet pressure for rapid door re-entry.



Equipped with 9 ft long NEMA 5-15P plug.

Side View

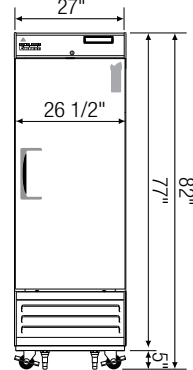
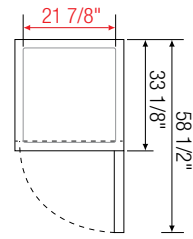
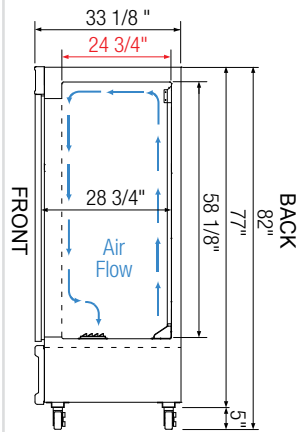

EBR1

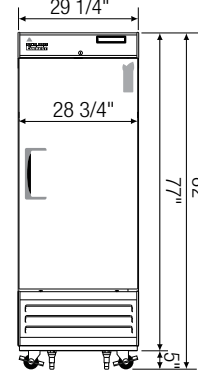
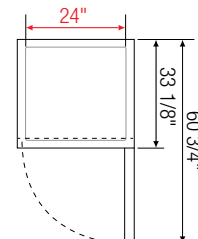

EBWR1

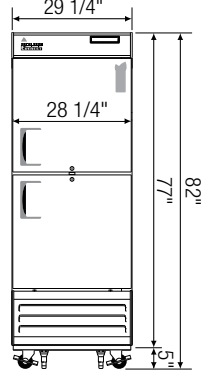
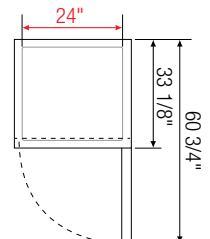

EBWRH2

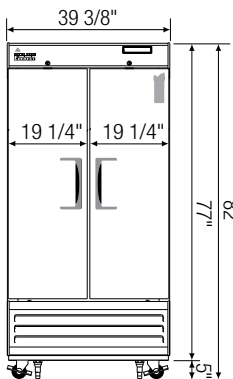
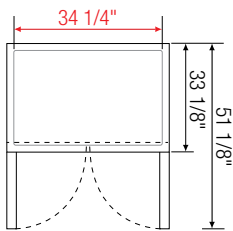

EBNR2

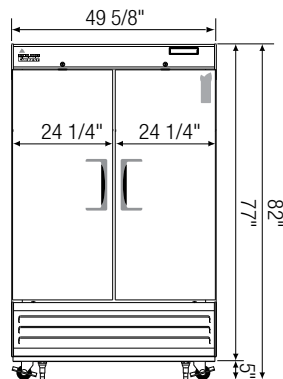
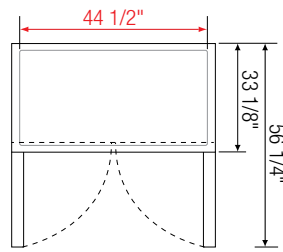

EBSR2

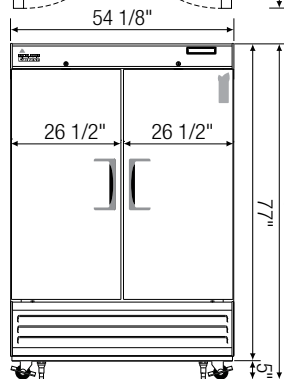
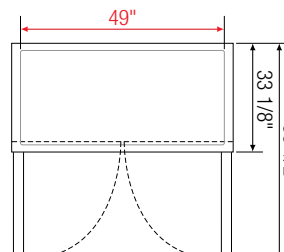

EBR2

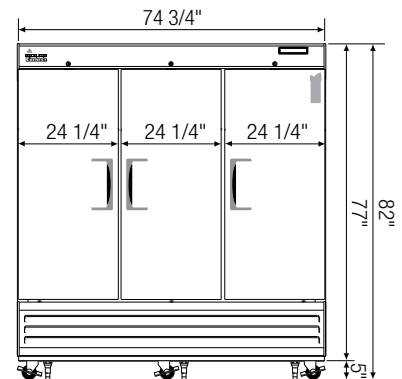
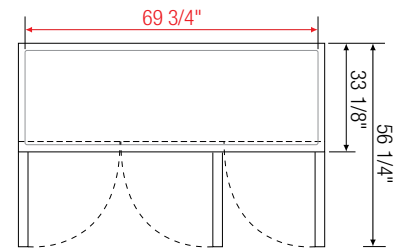

EBR3

| Model | Ref/ Frz/ Dual | # of Doors | Capacity [†] (Cu. Ft.) | HP | BTU/HR [†] | Refrigerant | # of Shelves | Power (V-Hz-Ph) | Amps | Crated Weight (LBS) | Exterior Dimensions (Inches) | | |
|--------|----------------------|---------------|------------------------------------|------|---------------------|-------------|-----------------|--------------------|------|---------------------------|---------------------------------|--------|----|
| | | | | | | | | | | | L | D | H* |
| EBR1 | Ref | 1 | 21 | 1/4+ | 1,852 | R290 | 3 | 115-60-1 | 3.7 | 336 | 27 | 33 1/8 | 77 |
| EBWR1 | Ref | 1 | 23 | 1/4+ | 1,852 | R290 | 3 | 115-60-1 | 3.7 | 341 | 29 1/4 | 33 1/8 | 77 |
| EBWRH2 | Ref | 2 (H) | 23 | 1/4+ | 1,852 | R290 | 3 | 115-60-1 | 3.7 | 348 | 29 1/4 | 33 1/8 | 77 |
| EBNR2 | Ref | 2 | 33 | 1/3 | 2,311 | R290 | 6 | 115-60-1 | 3 | 418 | 39 3/8 | 33 1/8 | 77 |
| EBSR2 | Ref | 2 | 48 | 1/3 | 2,311 | R290 | 6 | 115-60-1 | 3 | 471 | 49 5/8 | 33 1/8 | 77 |
| EBR2 | Ref | 2 | 50 | 1/3 | 2,311 | R290 | 6 | 115-60-1 | 3 | 520 | 54 1/8 | 33 1/8 | 77 |
| EBR3 | Ref | 3 | 71 | 3/4 | 4,445 | R290 | 9 | 115-60-1 | 7.5 | 670 | 74 3/4 | 33 1/8 | 77 |

* Height does not include 5" for casters.

† Based on evaporating temperature of 23°F (-5°C) & condensing temperature of 131°F (55°C).

Specifications subject to change without notice.

Product dimensions are for general purposes and not absolute value. Product capacity (†) is calculated based on standard industry figures. Slight variations may exist. If dimensions and capacity are critical, please contact Everest Refrigeration.

Ref = Refrigerator | (H) = Half Door