

# SM-50 Ice Cube Machine

## SM-50 Ice Cube Machine

### Models

- SM-50A



SM-50A

### Standard Features

- Produces up to 53 lbs. (24 kgs) of ice in 24 hours with storage capacity of 25 lbs. (11 kgs)
- Individual cubes with unique octagon shape.
- Designed to be installed into standard cabinet dimensions 15.00" (38.00 cm) or stand alone with stainless steel top and sides standard.
- Unit ships with hinge on right, easily changed to left during installation.
- Easily accessible control panel with the following functionality:
  - Automatic ice making mode.
  - Patented cleaning and sanitizing.
  - Delay start option.
  - Filter replacement warning light.
- Water filter system integrated inside machine with depth filtration and scale inhibitor.
- Lighted bin (LED light) with large opening for easy access.
- Optional drain pump easily integrates inside the machine during installation.

### Warranty

- 3-year commercial parts and labor warranty on entire machine.
- 1-year residential ice machine limited warranty.

### Cube Size

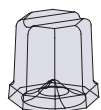

**Standard**  
1 3/8" x 1 3/8"  
(33x34 mm)c





## SM-50 Ice Cube Machine

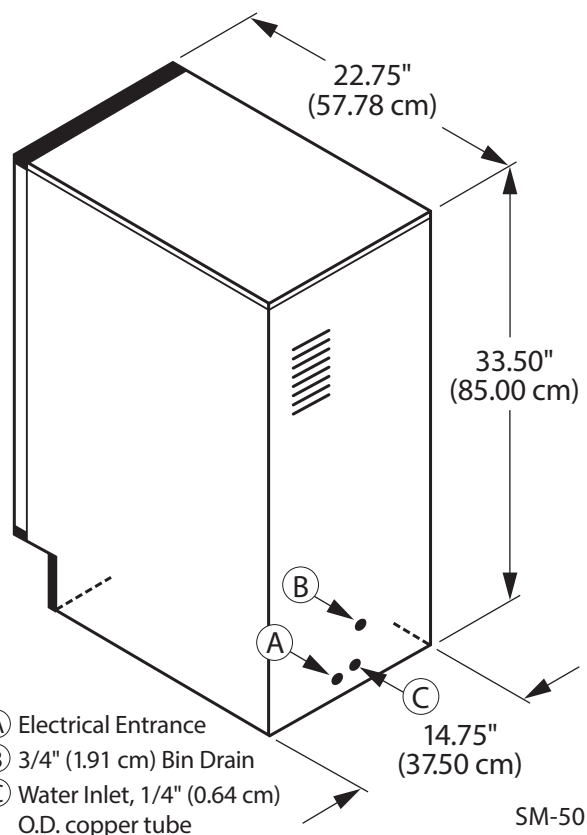

Installation Note - There is no minimum clearance required, designed to be integrated into cabinet opening 15.00" (38.00 cm) wide.

### Ice Machine Electric

**115/60/1** Factory pre-wired with a 6' (180 cm) power cord and NEMA 5-15P-plug configuration.

**Total Amps:** 4.1

**Max. fuse size:** 15 amps

HACR-type circuit breakers can be used in place of fuses.

### Specifications

#### BTU Per Hour:

1,145 (average) 2,300 (peak)

#### Compressor:

Nominal rating: 1/6 HP

#### Operating Limits:

- Ambient Temperature Range:  
50° to 110°F (10° to 43°C)
- Water Temperature Range:  
35° to 90°F (2° to 32°C)
- Water Pressure Ice Maker Water In:  
Min. 20 psi (138 kPa) Max. 80 psi (551 kPa)

#### Legs:

Levelers standard 0" to 1"  
(0-2.5 cm) adjustability.

Optional legs (K-00345) 4.25"-6.00" (10.80-15.24 cm).

#### Insulation:

Insulation foamed-in-place with CFC-FREE foam.

Modell	ce Shape	Ice production 24 hours				Power kWh/100 lbs @90°/70°F
		70° Air/50° F Water 21° Air/10° C Water		90° Air/70° F Water 32° Air/21° C Water		
		lbs.	kgsk	lbs.	gs	
SM-50A	Standard	53	24	44 lbs.7	20 kgs	.0
Water usage/100 lbs./45.4 kgs of Ice						
Potable Water: 43 gallons, 163 liters						

"A" following model number indicates "Air" cooled condensing unit.

#### Air Flow Front View



Air in the right,  
air out left,  
no side,  
vents.

#### Front Access Control Panel



Machine automatic keeps the bin full. Choose delay start for optimal quietness. Machine automatic restarts.

#### Water Filter



Auto-bypass for easy change out. Replacement water filter is AR-2800 (K-00374 12 pk)

Manitowoc Ice reserves the right to make changes to the design or specifications without prior notice.